

CORRUGATED SIDEWALL HALF-SIZE UTILITY RACK MODEL 280-1818A

FEATURES AND BENEFITS:

- Durable half-size utility rack ideal for extra work table or mobile appliance center.
- Reinforced stainless steel top provides a sanitary surface.
- Fully welded framework of structural aluminum extrusions for rigidity and durability.
- Constructed of non-corrosive, Hi-Tensile aluminum for strength.
- Corrugated sidewalls securely hold 18" x 26" pans on 1-1/2" centers without tipping. Provides added strength.
- Offers complete flexibility for operator's selection of pan spacing. Eliminates potential of product damage.
- Heavy duty 5" swivel casters, two with brakes. Provides mobility when fully loaded.



280-1818A



ACCESSORIES and OPTIONS (Available at extra cost):

- Cutting Board and Pan Assembly
- Pan Stop
- Corner Bumpers
- Vertical Bumpers
- Perimeter Bumper
- Rotary Bumpers (for use with 5" casters)
- Floor Lock (for use with 5" casters)
- Various Caster Options

See page G-36 for accessory details.



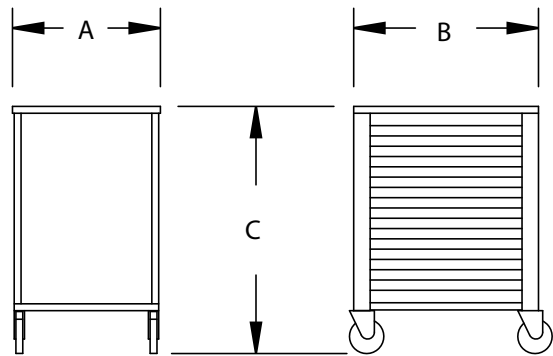
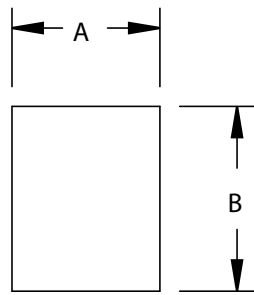
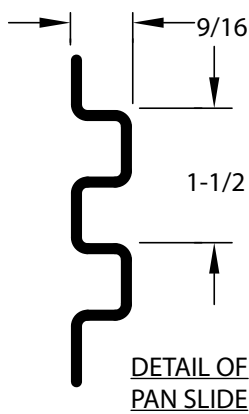

CRES COR MODEL NO.	PAN			DIM "A"	DIM "B"	DIM "C"	INSIDE DIMENSIONS				WEIGHT ACT.
	CAP	SIZE		WIDTH	DEPTH	HEIGHT	WIDTH	DEPTH	HEIGHT		
280-1818A	18	18 X 26	IN	21-13/16	26-15/16	36-1/16	18-1/16	26	27-13/16	LBS	62
		460 X 660	MM	555	685	920	460	660	710	KG	28

NOTES: 1. Send sample pan or tray with order when using any that are not 18" x 26" pans with heavy beaded edges.
 2. When ordering bumpers, add 2" to overall dimensions.

ALL ALUMINUM CONSTRUCTION IS RIVETED, WELDED AND FINISHED.



Gold indicates our Best Rack with the best warranty in the industry. 3-Year Parts / 1-Year Labor with lifetime guarantee against rust & corrosion

RACK:

- Top: Formed 16 ga. 304 stainless steel.
- Top, bottom and reinforcement channels: Extruded aluminum, 1-1/16 x 2-3/8 x .188; welded to posts.
- Posts: Extruded aluminum channels, 1-1/16 x 2 x .125.
- Sides: .063 aluminum corrugations riveted to posts.
- Casters: 5" dia., swivel, modulus tires, 1-1/4 wide, load cap. 250 lbs. each, temp. range -45°/+180°F. Delrin bearings. Two casters equipped with brakes.

PAN SLIDES:

- Corrugations act as pan slides on 1-1/2" centers.

SHORT FORM SPECIFICATIONS

Cres Cor Half-Size Utility Rack Model 280-1818A. Extruded aluminum welded construction with 16 ga. 304 stainless steel top. No-tip corrugated sides for (18) 18" x 26" pans on 1-1/2" centers. 5" swivel modulus casters, Delrin bearings. Load capacity 250 lbs. each, temperature -45° to +180°F. 3-Year Parts / 1-Year Labor warranty. Lifetime guarantee against rust & corrosion. Provide the following accessories: _____ NSF listed.



5925 Heisley Road • Mentor, OH 44060-1833
 Phone: 877/CRESCOR • Fax: 440/350-7267
 www.crescor.com
 © Crescent Metal Products, Inc. 2011 All rights reserved.

In line with its policy to continually improve its products, CRES COR reserves the right to change materials and specifications without notice.